



**Chuck Whalen - First Place
in the 1st Annual 10 K Race**



**Race Director Monica Robinette
at the Awards Table**

Photos Courtesy of Anastasia Nelson

**Monica Robinett
PO Box 5884
Corning, CA 96021**



Rancho Tehama 5 & 10 K

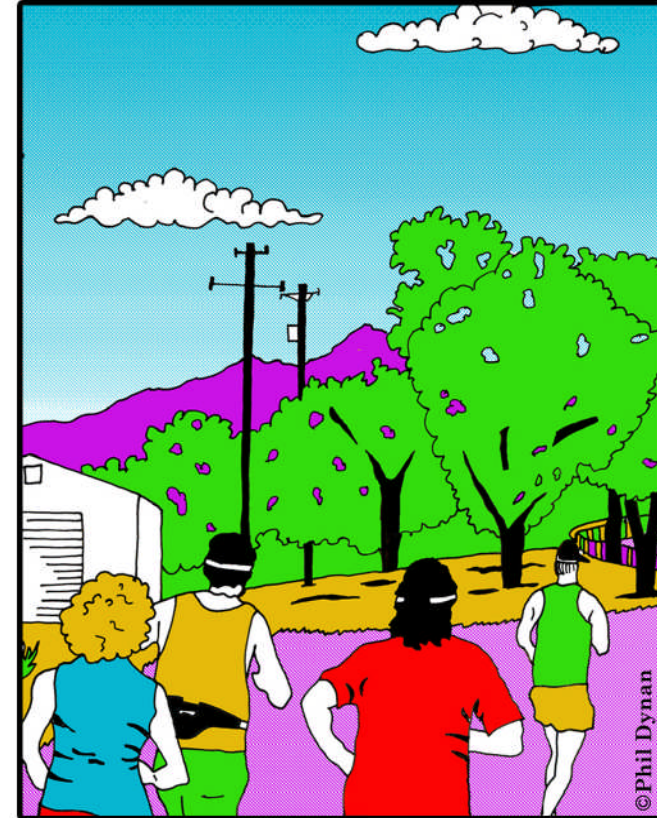

**2nd Annual Rancho Tehama
5K & 10 K Run
Saturday, October 1st
8:00 AM**

**Less than an hour from Redding
20 Minutes from Red Bluff
USTAF Certified Course
Scenic Area**

**All proceeds will benefit the Old
Time Volunteer Firefighters**

RANCHO TEHAMA 5K

CORNING, CALIFORNIA

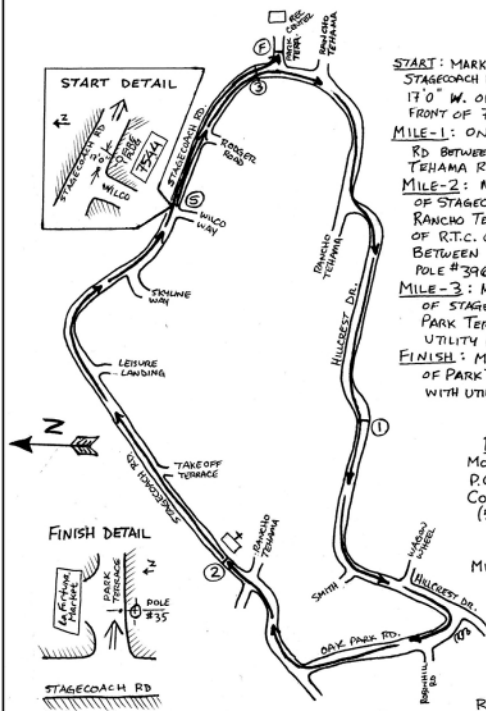

START: MARKER IS ON S. SIDE OF STAGECOACH RD AT WILCO WAY. 17'0" W. OF FIRE HYDRANT IN FRONT OF 7544 STAGECOACH.
MILE-1: ON N. SIDE OF HILLCREST RD BETWEEN SMITH & RANCHO TEHAMA RDS.
MILE-2: MARKER IS ON S. SIDE OF STAGECOACH RD BEFORE RANCHO TEHAMA RD, IN FRONT OF R.T.C. CHURCH, ALIGNED BETWEEN LIGHT POLE & UTILITY POLE #3969.
MILE-3: MARK IS ON S. SIDE OF STAGECOACH RD BEFORE PARK TERRACE. 30'0" E. OF UTILITY POLE #25.
FINISH: MARKER IS ON E. SIDE OF PARK TERRACE, ALIGNED WITH UTILITY POLE #35.

RACE DIRECTOR
 MONICA ROBINETT
 P.O. BOX 5884
 CORNING, CA 96021
 (530) 585-2903

CALIBRATION
 MIDWAY BIKE PATH 1,000
 CHICO, CA
 CA04032RS

MEASURER
 RANDALL J. BROWN
 CHICO, CA
 (530) 342-2923

NOTE: MAP NOT DRAWN TO SCALE
 MARKERS INCLUDE GREEN PAINT.

RANCHO TEHAMA 10K

CORNING CALIFORNIA

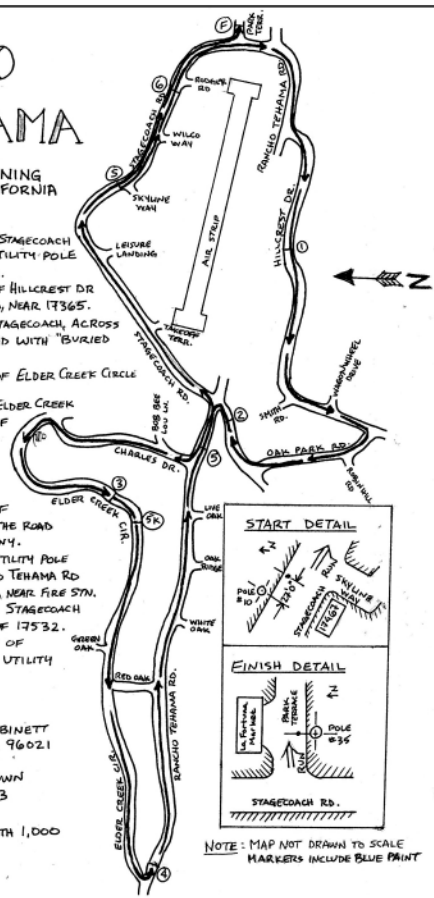

START: MARK IS ON N. SIDE OF STAGECOACH AT SHILINE WAY, 27'0" E. OF UTILITY POLE #10 ON N. SIDE OF THE ROAD.
MILE-1: MARKER IS ON N. SIDE OF HILLCREST DR BETWEEN SMITH & RANCHO TEHAMA, NEAR 17365.
MILE-2: MARK IS ON S. SIDE OF STAGECOACH, ACROSS FROM RECHLING CENTER, ALIGNED WITH "BURIED CABLE" BOX AND OAK TREE.
MILE-3: MARK IS ON NW. SIDE OF ELDER CREEK CIRCLE IN FRONT OF 17070.
5 KM: MARK IS ON N. SIDE OF ELDER CREEK CIRCLE AT 17040, 32'0" W. OF UNMARKED UTILITY POLE IN FRONT OF 17035.
MILE-4: MARKER IS ON N. SIDE OF RANCHO TEHAMA RD NEAR ELDER CREEK CIRCLE, 12'0" W. OF UNMARKED POLE ON S. SIDE OF THE ROAD NEAR DUCOR TELEPHONE COMPANY.
MILE-5: MARK IS 18'0" W. OF UTILITY POLE #8512 ON S. SIDE OF RANCHO TEHAMA RD BETWEEN CHARLES & STAGECOACH, NEAR FIRE SYN.
MILE-6: MARK IS ON S. SIDE OF STAGECOACH RD NEAR RODGER RD, IN FRONT OF 17532.
FINISH: MARKER IS ON E. SIDE OF PARK TERRACE, ALIGNED WITH UTILITY POLE #35.

RACE DIRECTOR: MONICA ROBINETT
 P.O. BOX 5884, CORNING, CA 96021

MEASURER: RANDALL J. BROWN
 CHICO, CA (530) 342-2923

CALIBRATION: MIDWAY BIKE PATH 1,000
 CA04032RS

NOTE: MAP NOT DRAWN TO SCALE
 MARKERS INCLUDE BLUE PAINT

2nd Annual Rancho Tehama Run 1 mi/5K/10K Run/Walk USATF#: CA10089RS/CA10088RS Registration Form

Sign up for:	Time:	Price:
1 mi walk/run	8:30am	\$10.00
5K walk/run	8:15am	\$10.00
10K run	8:00am	\$10.00
Kid's (12 and under, 1 mi only)		free

(add \$10.00 per T-shirt order)

Late registration fee add \$5.00 (After Sept 27)

T-Shirt Size: S M L XL XXL
 (Circle one)

Please make checks payable to:
 Community Foundation

Name _____

Address _____

City/State _____

Sex (circle one) M F Age _____

Phone _____

E-mail _____

2nd ANNUAL RANCHO TEHAMA 5K & 10 K RUN SATURDAY OCTOBER 1st, 2011 8:00 AM

(Please plan to arrive at 7:30am to check in, rain or shine)

Thank you to our sponsors:
 Ducor Phone Co.
 Red Bluff Art Gallery
 And volunteers!

All proceeds will benefit the Old Time Volunteer Firefighters

Please mail completed application to:

Monica Robinett
 PO Box 5884
 Corning, CA 96021

Race location:

17605 Park Terrace
 Rancho Tehama Reserve
 Corning, CA
 (530) 585-2903

Please plan to arrive at 7:30am to check in Rain or Shine!

Ten minutes west of I-5, between Red Bluff and Corning. Use Mapquest for a specific map. When you reach Rancho Tehama, turn right, then right again at first street. Transportation to race start is provided for runners.

Waiver: intending to be legally bound, I certify that my training and health are adequate for me to safely compete in the Rancho Tehama 1mi/5K/10K and hereby waive any claims for damages I may suffer due to participating in this event:

Signature (parent or guardian if under 18)
 Date _____